

Sahara

INSTALLATION MANUAL

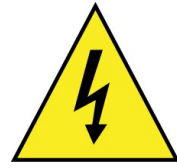

IP20



Class I

- The luminaires are electrically insulated and provided with a connection to earth.
- Earthing protects exposed metal parts that could become live in the event of basic insulation failure.

Installation Requirements

- This light fixture must be supplied with 220-230V, 50Hz AC power.
- Connect to an individual branch circuit.
- LLSA ensures a 2 kV surge protection on our PSU, anything out of this range will void warranty provided.
- Improper installation might cause an electric shock accident.
- Use an authorized electrical professionals to do the installation, repair and maintenance of the light fixture.
- Cut off the power before and during installation, maintenance and repair of the light fixture.
- Do not install the light fixture on top of or near hot objects to avoid damage. (For example hot gas pipes, exhaust funnels or stoves)
- Do not install the light fixture in a damp area or where liquid leakage is potential.
- Make sure no fire regulations are violated.
- Do not look directly at the light fixture for a long period of time to avoid eye damage.
- The use of third party equipment is not recommended by the manufacturer for it may lead to warranty void.
- Do not cover the lamp with heat insulating gasket or similar material.

Non-user replaceable light source

- The light source contained in this luminaire shall only be replaced by the manufacturer or his service agent or a similar qualified person.

Cleaning and Maintenance of Enclosure

- Do not use solvent-based cleaning agents, this will cause cracks to form in the plastic diffuser covers.
- Clean with a damp cloth and silicone-based cleaning agent. (Such as Mr Min)

Product Information

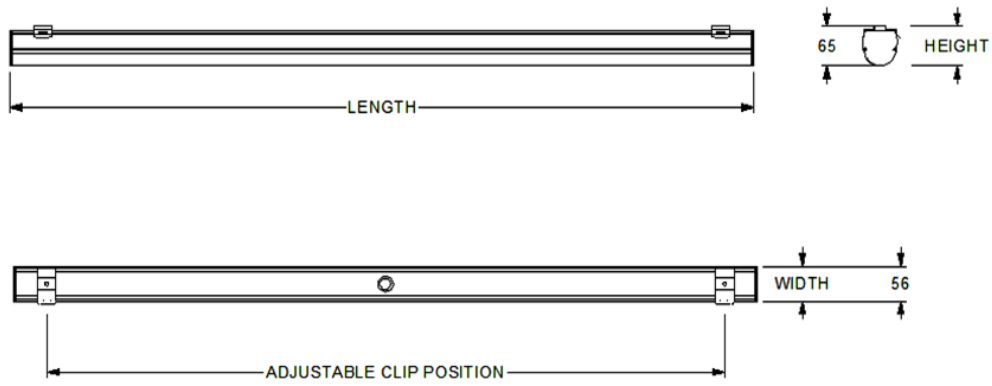

DIMENSIONS: Length x H65 x W56 mm

PRODUCT WEIGHT: 0.5 / 2kg

PACKAGED WEIGHT: 0.55 / 2.05kg

Note

- Ensure straight alignment between mounting brackets. Failure to do so may result in damage or loss.
- Ensure correct mounting clip interfacing with fixture to avoid damage or loss.

SURFACE MOUNTING: DRILLING HOLES FOR CLIPS



IMPORTANT: POOR CLIP ALIGNMENT COULD RESULT IN DAMAGE OR LOSS

SURFACE MOUNTING: CLIP SPACING

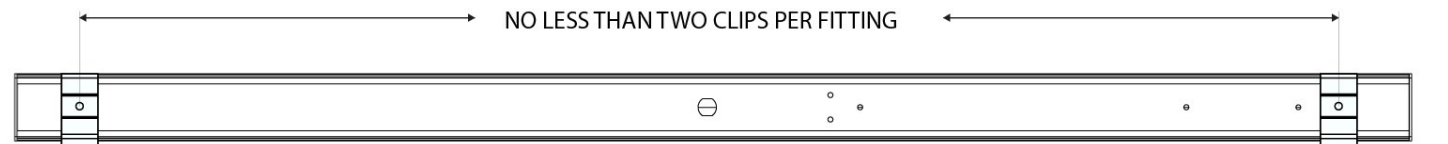

ADJUSTABLE CLIP POSITIONS →

← ADJUSTABLE CLIP POSITIONS

IMPORTANT: POOR CLIP INTERFACE WITH EXTRUSION COULD RESULT IN DAMAGE OR LOSS

Installation Equipment & Parts List

Equipment (not included)

- | | Quantity |
|--------------------------------------|----------|
| • Screw driver | 1 |
| • Drill and appropriate drill bit | 1 |
| • Spirit level (suspension mounting) | 1 |

Part list (As specified when order placed)

- | | Quantity |
|---|----------|
| • GL surface mounting clip | 2 |
| • Relevant parts listed by installation instruction | |

Instructions (steps to follow)

- Surface Mounting

STEP 1: Drill hole for fissure plug

- **IMPORTANT : Contractor is responsible for determining the appropriate fastener for surface mounting in the applicable material and must ensure adequate support for 1.65kg/m**
- Mark where the hole needs to be drilled, ensuring alignment.
- Drill an M6 hole for the fissure plug.
- Insert the fissure and screw mount the bracket securely. (Fig 1)

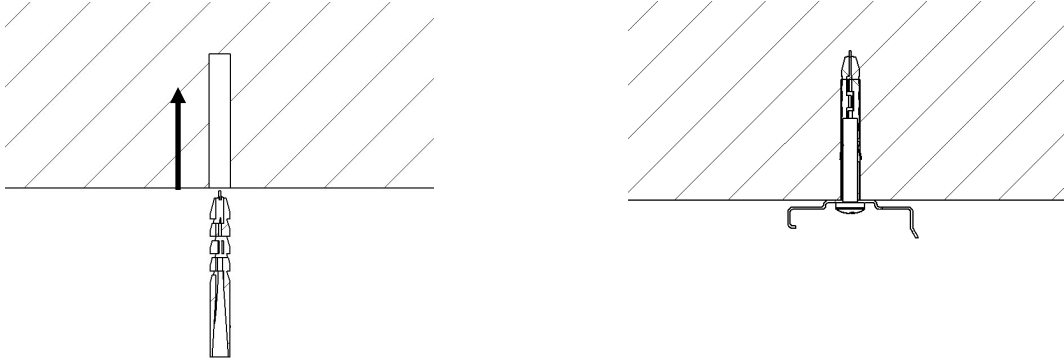

FIG. 1

STEP 2: Clip in fitting

- Clip the fitting as shown below, you will hear a CLICK when the bracket is secure. (Fig. 2)
- Follow power connection steps found the last page of this document.

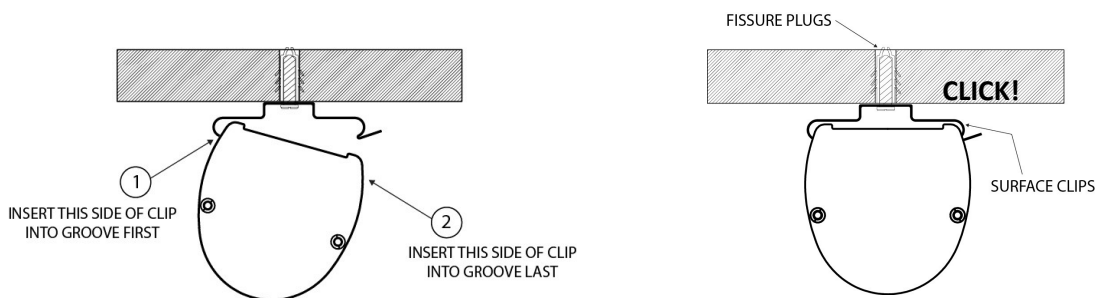

FIG. 2

Instructions (steps to follow)

- Suspension Mounting (Gripple Kit)

Part list and Quantities (As specified when order placed)

1. Surface mounting clip
2. Gripple kit
3. Steel cable



Instructions (steps to follow)

- Suspension Mounting (Gripple Kit)

Observe mounting spacings

1. Do not use fewer suspension points than referenced.
2. Confirm spacing between mounting points is equidistant.
3. Allow 100mm minimum steel cable lead out from Gripple clasps.

Product	Suspension
Sahara 1200	2
Sahara 1500	2
Sahara 2200	3
Sahara 590x590	2
Sahara590x865	2

STEP 1: Mounting suspension points

- Determine suspension point locations by referring to layout drawing and above quantity recommendation.
- Mount suspension points to ceiling or roof structure. **Contractor to determine fixture method and to supply required parts suited to the surface material / structure and load.**
- If no suitable attachment points are available on the ceiling structure then it is advised that P2000 must be installed from which the luminaires can be suspended. The P2000 should follow the shape of the luminaire assembly.
- Ensure suspension points are positioned directly above the desired location of the fittings as suspension points located to either side may cause the completed luminaire structure to bend out of alignment.

STEP 2: Mounting the luminaires

- Clip the fitting into clip position as shown in Fig 2 above. Hear the CLICK when the bracket is secure.
- Inspect & confirm the clip for correct engagement.
- Using spirit level, adjust suspension cables at fitting to ensure level alignment.
- Pull on each suspension set to confirm complete assembly is secure robust.

WARNINGS :

Incorrect concrete / fissure plugs suited to specific project requirements may result in mounting failure.

Improperly secured rear clips may result in mounting failure.

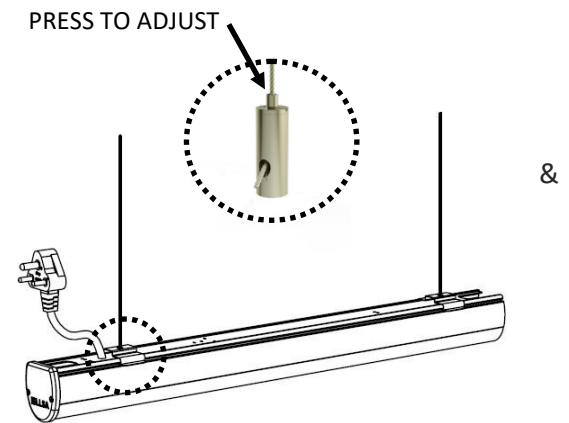

FIG. 1